

# Priming the Compound and Water

Before you prime the pumps, If your model has them (and some do not) remove the black polish compound nozzle caps and set aside



1. Find a small container or use a piece of paper towel to catch water and compound from the nozzles during the priming process.



## Priming the Water Pump

2. Press and hold "START" button, and then press "FUNC" button. The LCD displays "Water Pump ON", and the Water Pump begins running.

*NOTE: You will hear a rhythmic clunking sound each time the water pump operates.*

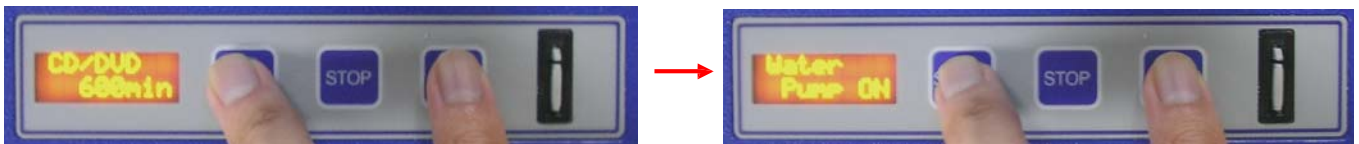

It may take several minutes for water to come out of the nozzles. If you do not see water after that time, gently squeeze the sides of the water bottle to push water into the tubing and clear the air.

If the water still does not come out, press Stop. Remove the lid from the water bottle and use a can of compressed air to blow some air through the tubing until you feel air coming out of the nozzles. Repeat step 2.

## Priming the Water Pump Cont'd.

The water will not come out in a steady stream, but a few drops should come out each time the pump engages.

3. Press any button on the Operation Panel to stop the pump after confirming that water is coming from both Water Nozzles. The display on the LCD returns to "CD/DVD" or "BD" with the remaining time of the KEY CARD.

## Priming the Compound Pump

1. Press and hold "STOP" button, and then press "FUNC" button. The LCD displays "Compound Pump ON", and the Platen Table begins rotating clockwise to run the Compound Pump.



It may take several minutes for the compound to fill the lines and drip out of the nozzles.

2. Press any button on the Operation Panel to stop the Platen Table after confirming that compound comes out from both Compound Nozzles. The display on the LCD returns to "CD/DVD" or "BD" with the remaining time of the KEY CARD.



**IMPORTANT: On a daily basis, run these tests to confirm that water and compound are coming out from each nozzle before using the machine.**

**If your machine has not been primed for a while OR sitting unused then follow these instructions**

- 1 make sure the polish nozzles are not blocked ( carefully use a paper clip and do not push in too far)
- 2 Ensure polish is in bottle then Prime polish for 2 minutes
- 3 Reverse prime for 2 minutes
- 4 Wait for 40 minutes then repeat process until the polish starts flowing (could take several attempts)